

## FOR LEASE

3731 E. OLYMPIC BLVD, LOS ANGELES, 90023



For Additional Information,  
Contact:

[info@nickhadim.com](mailto:info@nickhadim.com)

310-836-2121

6009 Washington Blvd.,  
Culver City, CA 90232

[www.nickhadim.com](http://www.nickhadim.com)

LIC. # 01885300



**NICK HADIM**  
GROUP OF COMPANIES

## Creative Live/Work Studios

### Property Highlights:

- Former Victory Outreach Church
- Five New York Inspired Live/ Work Spaces
- Open Floor Plan with Polished Concrete Flooring
- Natural Light/ Several Large Windows/Skylight
- Private Restroom With Shower & Kitchenette
- Gated Parking
- Prime Boyle Heights Location
- Easy 5/101/10 FWY Access
- Just 2 Miles to Arts District DTLA

Unit 104 APX. 1,000 SF \$2,275

ALL INFORMATION DEEMED RELIABLE BUT NOT GUARANTEED

# FLOOR PLAN

3751 E. OLYMPIC BLVD., LOS ANGELES, 90023

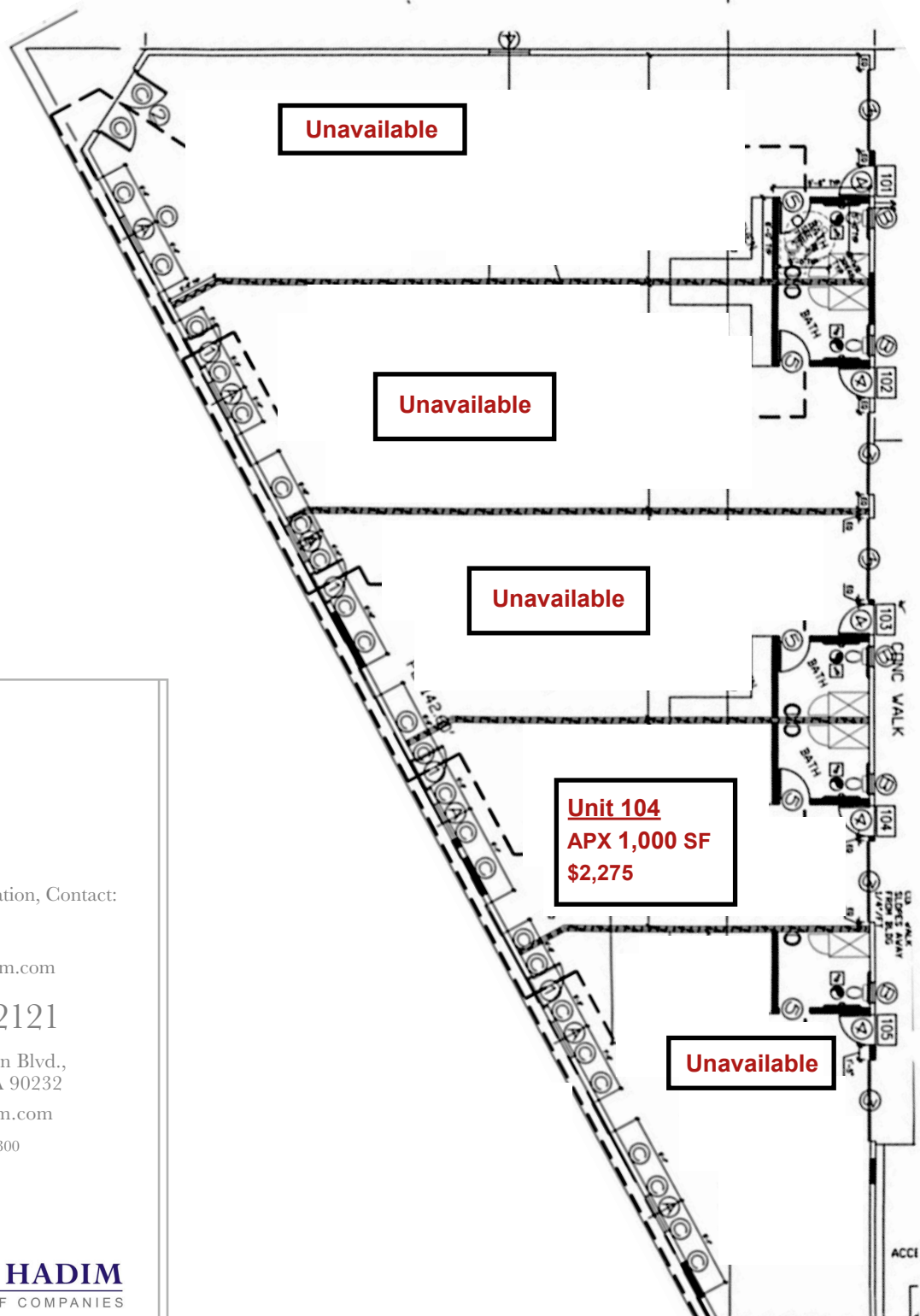

For Additional Information, Contact:

[info@nickhadim.com](mailto:info@nickhadim.com)

310-836-2121

6009 Washington Blvd.,  
Culver City, CA 90232

[www.nickhadim.com](http://www.nickhadim.com)

LIC. # 01885300



**NICK HADIM**  
GROUP OF COMPANIES

ALL INFORMATION DEEMED RELIABLE BUT NOT GUARANTEED

# THE STORY

3751 E. OLYMPIC BLVD., LOS ANGELES, 90023



For Additional Information, Contact:

[info@nickhadim.com](mailto:info@nickhadim.com)

**310-836-2121**

6009 Washington Blvd.,  
Culver City, CA 90232  
[www.nickhadim.com](http://www.nickhadim.com)

LIC. # 01885300



**NICK HADIM**  
GROUP OF COMPANIES

## The History

Since their humble beginning in the early 60s, Victory Outreach grew from one church at 3751 E. Olympic Blvd. to a worldwide network of over 700 churches and ministries, with locations across America and in 30 countries from the Philippines to the Netherlands.

Almost 50 years latter, we got our hands on their original location which was reimagined by us into what we call "Flats 3751". We decided to keep its original charm, and convert it into Live/ Work Studios to suit today's Living/ business world.

The subject offers 9 Creative Live/Work Studios, and 1 Commercial Unit, of different sizes in two floors with an arcade that serves as a corridor.

As you walk into the building you enjoy the natural light that shines through the massive skylights, and totally feels like outdoor. High Wood Beam Ceiling and allure all over the place.

Reserve your space in the brand new Flats 3751 where you get to live/ work, and play!

Owned and operated as a church by The Victory Outreach since the early 60s.